

IF YOU HAVE ANY QUESTIONS OR CONCERNS, OR ARE MISSING PARTS, DO NOT RETURN SPRAYER TO THE STORE!

PLEASE CALL OUR CONSUMER HOTLINE AT 1-800-9-SPRAYER

(1-800-977-7293)

Visit us on the Internet: www.hdhudson.com

Instruction 871-200 Poly Sprayer Instructions

1 Before you assemble and use your sprayer, read the following Safety information. It is helpful and important!

DANGER!

This sprayer operates with liquid under pressure. Failure to observe CAUTIONS and follow instructions for use and maintenance can cause tank, hose or other parts to become corroded, weakened, and/or burst. This can result in SERIOUS INJURY or PROPERTY DAMAGE from forcible ejection of parts or high-pressure discharge of spray material.

DO NOT USE ANY FLAMMABLES IN THIS SPRAYER as it is not designed nor intended for such use. Some spray materials can ignite or explode. Do not spray in an enclosed space, near an open flame such as found in a BBQ grill or water heater, near an electric motor or open switch, or any source of heat.

DO NOT SMOKE while spraying. Use of flammables could result in SERIOUS INJURY or PROPERTY DAMAGE from unintended ignition or explosion.

DO NOT USE ANY CAUSTICS OR ACIDS IN THIS SPRAYER, since these can damage or weaken the spray and its parts, resulting in SERIOUS INJURY or PROPERTY DAMAGE.

CAUTION!

- Before using any pesticides or any other spray material in your sprayer, **READ THE LABEL ON THE SPRAY MATERIAL CONTAINER AND FOLLOW EXACTLY ITS INSTRUCTIONS FOR MIXING AND USE INCLUDING THE NEED FOR PROTECTIVE CLOTHING**. Some spray materials are dangerous and should not be used in this sprayer as they can damage the sprayer or its parts, or may be harmful to the user. This could result in SERIOUS BODILY INJURY or PROPERTY DAMAGE.
- **BEFORE USING YOUR SPRAYER**, thoroughly **INSPECT** both inside and outside of the sprayer. Be sure the hose is securely attached to the tank and on/off valve, and that the spray wand and nozzle are attached and not damaged. A loosely connected hose, on/off valve, spray wand or nozzle can come off when sprayer is under pressure and cause SERIOUS INJURY or PROPERTY DAMAGE.
- **DO NOT PRESSURIZE** sprayer if tank, hose or other parts appear to be damaged, discolored, brittle, excessively soft or loose.
- **DO NOT PUMP** or use sprayer with head or body over pump as pressure in sprayer can forcibly eject pump if it is not properly locked in place, and this can cause SERIOUS INJURY.
- **DO NOT** use hot or boiling liquids in sprayer since this may weaken or damage tank, pump or hose.
- **DO NOT PRESSURIZE WITH ANY MECHANICAL DEVICE** such as an air compressor, since this can create dangerous pressure and bursting of parts and result in SERIOUS INJURY.
- Wear long-sleeved shirt, pants, gloves, goggles or similar protective clothing when spraying
- Do not leave residue or spray material in sprayer after use. It may damage or clog the sprayer or its parts.
- Empty, clean and drain sprayer tank and hose after each use, according to directions.
- Do not smoke or eat while mixing spray materials or spraying, and wash up afterwards.
- Use only Hudson replacement parts when servicing your sprayer. Other parts may not fit properly or may be weakened by spray materials and fail under pressure, resulting in SERIOUS INJURY from forcible ejection of parts or unexpected high pressure discharge of spray material.
- **WARNING:** keep sprayer and all spray materials away from children and pets.

WARNING! Make sure you RELEASE ALL THE PRESSURE in the sprayer..

- Immediately after each use, even if you stop spraying for just a few minutes.
- Before removing pump, hose, spray wand or nozzle.
- Before trying to unclog nozzle, spray wand, shut-off valve or hose.
- Before servicing sprayer in any way.
- Before use when sprayer is left in the sun or other warm place for an extended period of time.

LIMITED WARRANTY

- 10 YEARS: Classic Plus™
- 5 YEARS: Comando™, PumpLess™, Bugwiser®, Suprema® Poly Bak-Pak®, Yard & Garden®, Bak-Pak®
- 3 YEARS: Porta-Spray™, Water Wagon™
- 2 YEARS: Yard and Garden™, Multi-Purpose™, Leader®, Farm & Garden™, Dusters
- 1 YEAR: X-Pert®, Professional™ sprayers, Super Sprayer, Industro®, Constructo, Suprema® Stainless Steel Bak-Pak®, Commercial sprayers, Regulator™, NeverPump™, Farm Tough™, Team Quencher™, Foam-a-Matic™, Stain-Preserve-Seal™ (SPS) and Surface Applicator sprayers, Bleach-Solutions™, Favorite®, EZ Applicator™, Deck and Fence™, Quick 'n Easy™, Weed 'n Bug Eliminator™, Eliminator™, Eco™, Trombone®, Walk 'n Water™.
- 90 DAYS: Fog®

H. D. Hudson Manufacturing Company warrants to the original consumer purchaser of this product at retail that it is free from defects in materials and workmanship for the period specified above from the original date of purchase. This warranty does not apply to damage to the product resulting from accident, misuse, neglect, alteration, modification, tampering, or failure to follow instructions supplied with the product. This warranty does not cover normal wear and tear of o-rings or seals, and, except for Tek®, X-Pert®, Comando™, Constructo®, Industro®, and ULV™ sprayers, the warranty shall be void if the product is used commercially. If the product or any part of it should malfunction within the warranty period, telephone our CUSTOMER SERVICE DEPARTMENT at 1-800-977-7293 for fast service. We will, at our option, repair or replace any problem parts free of charge. This warranty is valid in North America. You must retain your sales receipt as proof of the date of purchase and include it with any return of the product.

ANY IMPLIED WARRANTIES, INCLUDING ANY IMPLIED WARRANTY OF MERCHANTABILITY OR FITNESS FOR CONSUMER USE, ARE LIMITED TO 1 YEAR. H. D. HUDSON MANUFACTURING COMPANY EXCLUDES LIABILITY UNDER THIS WARRANTY FOR ANY AND ALL INCIDENTAL AND CONSEQUENTIAL LOSS OR DAMAGES.

Some states do not allow limitations on how long an implied warranty lasts or the exclusion or limitation of incidental or consequential loss or damage, so these limitations or exclusions may not apply to you. This warranty gives you specific legal rights, and you may also have other rights which vary from state to state.

2 Here's How to assemble your sprayer

If any part is missing, please call 1-800-9-SPRAYER (800-977-7293) to order a replacement.

Check carton for:

- Sprayer Tank with (may include Pressure Relief Valve, Quick Connect or hose adapter nut)
- Pump (A) in tank
- Hose Assembly with fitting and nut (may be loose in tank)
- Shut-off Valve (B) (may be assembled to hose)
- Spray Wand (C) with Nozzle (may be loose in tank)
- Supply Tube (D)
- Instructions (E)

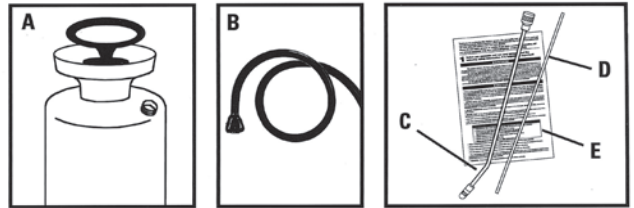

2a. Insert supply tube into bottom end of hose fitting. Assemble supply tube filter to the bottom of the supply tube if so equipped.

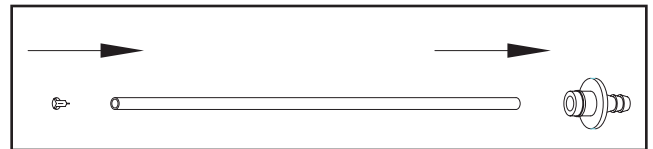

2b. Insert hose into non-threaded end of nut and push all the way through. Push hose onto hose barb. **IMPORTANT:** BE sure hose covers entire hose barb! If the hose is too hard to assemble to the barb, pour hot water over the end of the hose to soften it up.

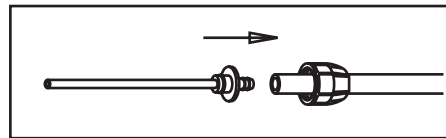

2c. Securely thread the cap nut onto the tank fitting. **NOTE:** This is a compression fitting. It will screw on tightly. **CAUTION:** make sure the cap nut is threaded all the way down. If loose, it may come off with force, or spray may escape, resulting in **SERIOUS INJURY**.

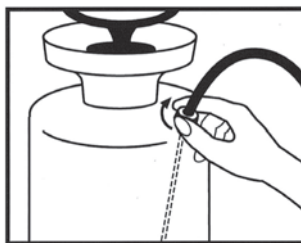

2d. Attach the wand to the shut-off valve. Squeeze the handle for easier assembly.

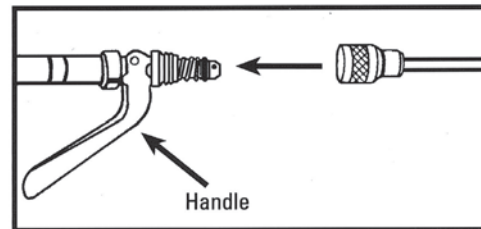

If the shut-off valve is not assembled to the hose, use section 2e, 2f, or 2g to complete your sprayer.

2e. For sprayers with a poly shut-off valve/wand combination: Follow steps 2a through 2c, then:

- Insert hose into non-threaded end of handle and push all the way through the handle.
- Push hose onto end of shut-off valve. **IMPORTANT:** Be sure it is all the way over the barb!
- Screw handle on to the shut-off valve.

Note: This is not a compression fitting, but it is normal for it to screw on tightly.

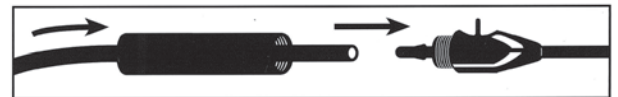

2f. For sprayers with a poly shut-off valve: Follow steps 2a through 2c, then:

- Insert hose into non-threaded end of nut and push all the way through.
- Push hose onto end of shut-off valve: **IMPORTANT:** Be sure it is all the way over the barb! Screw nut onto the control valve.

Note: This is not a compression fitting, but it is normal for it to screw on tightly. Insert spray wand into shut-off valve. Screw cap nut to shut-off valve.

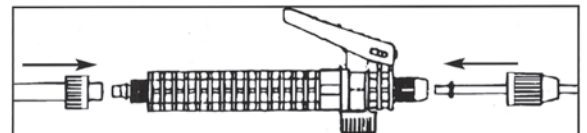

2g. For sprayers with a poly Thrustless™ shut-off valve: follow steps 2a through 2c then:

- Insert hose fitting into shut-off valve handle.
- Screw down hose nut onto handle.
- Insert spray wand fitting into shut-off valve. Screw down wand cap nut onto shut-off valve.

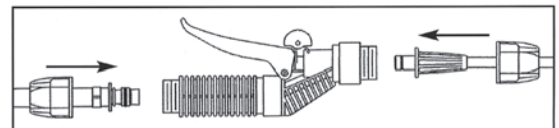

3 Here's Fill Your Sprayer

Before filling, be sure to read, understand and follow exactly the label instructions on spray material container!

3a. With pump handle all the way down and in the locked position (A), turn to left (B) and lift out the pump (C)

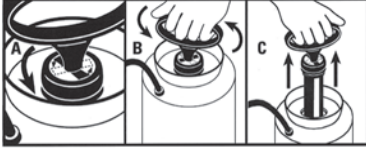

3b. Pour measured amount of spray material into the open tank. Follow label directions on spray material container for amount to use.

NOTE: Do not try to remove pump by unscrewing pump cap. Doing so will cause pump cylinder to stay inside the tank and you will not be able to fill it.



3c. Add water as directed. Don't fill beyond the MAX FILL line. Replace pump and turn (clockwise) into place, turning only hard enough to seal.

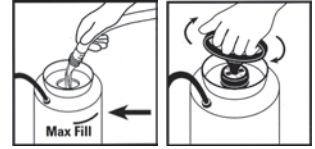

NOTE: If using a PumpLess™ Sprayer, follow steps 3a and 3b. Replace pump without filling tank with water.

4 Here's how to pressurize (pump up) your sprayer

4a. Unlock pump handle by pushing down and turning handle. Do not unscrew pump cap or remove pump.



4b. Using the handle, pump up and down. The more you pump, the more pressure you will build up inside the tank. When it becomes difficult to pump, your tank has reached maximum pressure. Do not stand with your head over the pump.

NOTE:

- Use low pressure (fewer strokes) for a coarse spray
- Use high pressure (more strokes) for a fine mist or a long-reaching stream.



4c. If using a PumpLess™ Sprayer

1. Seal the pump. Run water through garden hose to remove excess air. Turn off water. Thread connector onto hose.
2. Push connector onto red adapter on tank. Turn on water and fill to "MAX FILL" line on tank; shut water off. Pull back collar on the quickcoupler to remove it from the sprayer. The air trapped inside the tank has been compressed by the water and you are ready to spray.

NOTE: If you release the pressure before using all the spray material, use the conventional method 4b to repressurize sprayer.

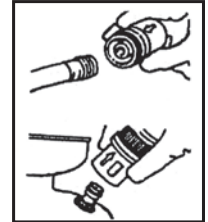

5 Here's How to Spray

5a. For sprayers with metal Roto-valve™ shut-off

Squeeze handle to spray.

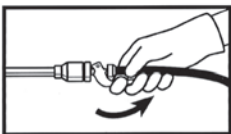

Release Handle to Stop

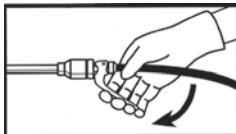

5b. For sprayers with poly shut-off valve

Push to spray

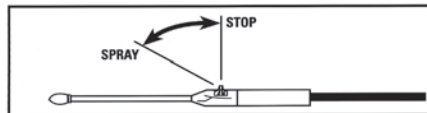

Pull back button to stop

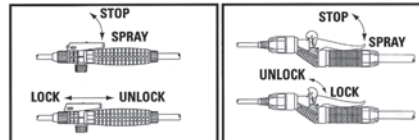

5c. Identify Spray Patterns

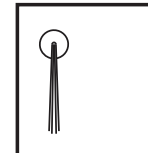

COARSE



FINE MIST

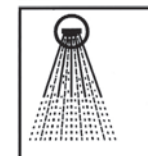

FAN

5d. Adjust the Nozzle

Cone/stream nozzle

Tighten nozzle for fine mist

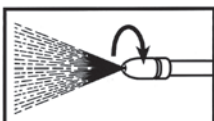

Cone/Stream nozzle

Loosen nozzle one full turn for coarse or long range



Fan nozzle

Loosen nozzle one full turn for fan spray

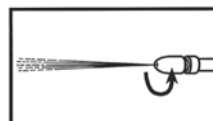

NOTE:
If you tighten the fan nozzle all the way down, the spray may stop completely.

6 Here's how to release the pressure in your sprayer

Warning: always release pressure before trying to service sprayer in any way or before removing or disconnecting nozzle, spray wand, shut-off valve, hose or any other part!

6a. Turn sprayer upside down and turn nozzle away from you. Squeeze lever or push button to on and let all the air escape.



6b. Turn sprayer up-right and slowly unscrew pump from tank and remove it. Keep face & body away from pump.

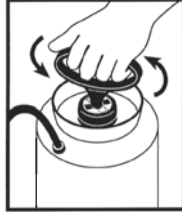

6c. If your sprayer is equipped with a pressure release valve on the tank, you may twist the top portion open and hold it until all air has escaped. Twist valve closed to reseal. Then remove pump.

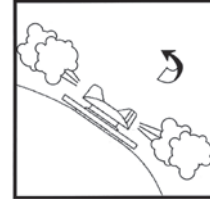

7 Here's how to service and maintain your sprayer: Important TIPS and information

A. Clean and dry your sprayer after every use to greatly prolong its useful service life. Many spray materials will harden if left in the sprayer and plug up the nozzle, shut-off valve or supply tube. Do not store your sprayer with pump tightened in the tank.

B. The soft parts---O rings and gaskets will ultimately wear out and need replacing, just like the oil filter on your car. How often they need replacing depends on how much you spray, the spray materials you use, and whether or not the sprayer is regularly cleaned after use.

C. If you leave your sprayer in the garage over winter, particularly in the northern areas, the soft parts may dry out and need servicing before you use your sprayer for the first time in the Spring. Lubricate soft parts with petroleum jelly before storing.

WARNING!

Make sure all of the pressure in your sprayer is released according to instructions in item 6 before cleaning or servicing your sprayer in any way or before removing any part of it!

7a. Clean your sprayer each time you finish using it to help keep it trouble free.

1. When finished with job, spray away all the material in your sprayer or empty it into original spray material container.
2. Remove pump and add some clean water and a few drops of liquid dish washing soap.
3. Replace pump and shake tank to mix soap and water.
4. Pressurize and spray out soapy solution.
5. Release any pressure remaining and remove pump.
6. Remove hose and supply tube by unscrewing connection at tank. (No tools required)
7. Turn tank upside down and let dry.
8. Holding hose and spray wand up, open shut-off valve and let wand and hose drain.

Tip: Back-flush your wand, hose and supply tube with a garden hose for maximum cleansing.

Maintenance Kit

A maintenance kit containing your sprayer's soft parts may be available from your local dealer, or you may order by calling 1-800-9-SPRAYER



7b. If you have trouble pumping your sprayer, or if liquid gets inside pump:

- A. Plunger assembly/pump handle
- B. Pump Cap
- C. Cylinder gasket
- D. Cylinder Assembly
- E. Plunger Cap
- F. Pump Cylinder Check Valve

To open pump assembly: Unscrew pump cap (B) and pull out plunger assembly (A) from cylinder (D)

If the pump leaks at the tank opening: Clean or replace the cylinder gasket (C)

If pumping doesn't pressurize your sprayer: Lubricate the plunger cup (E) with petroleum jelly or replace. (You may need to do this if you do not use sprayer for a prolonged time especially over winter). If pump won't pressurize and/or liquid gets into the pump: Clean or replace the pump cylinder check valve (F).

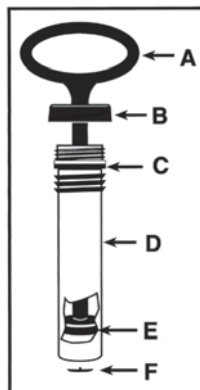

Pump maintenance instructions for owners of Weed 'n Bug Eliminator™, Eliminator™, and Rose & Garden™ sprayers.

1. Lift up (extend) plunger handle and rod from cylinder.
2. Lay pump on flat surface and hold securely.
3. Insert small screwdriver into slot in cylinder.

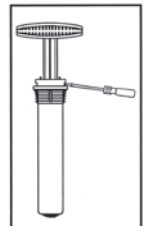

4. Push in and carefully push up to disengage locking tabs on collar. Do not use excessive force. Collar does not pop out. Work both slots. Pull up on plunger handle. Plunger will pull out and separate from cylinder if locking tabs on collar are disengaged.

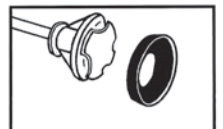

CAUTION!

Make sure pressure is released **BEFORE** removing cap nut. Always make sure cap nut is securely tightened onto tank before pressurizing.

7c. If you have a leak at hose connection or if nothing but air comes out of nozzle:

Removing hose and supply tube: Release pressure! Unscrew the cap nut (no tools required) and lift hose and supply tube out.

If sprayer leaks at hose connection: Clean and tighten cap nut or replace the O-ring inside cap nut.

If you pump up the sprayer and nothing but air comes out of the nozzle:

The supply tube has become loose. Release pressure in tank. Remove the cap nut and hose, and re-insert the supply tube into the hose and then reassemble to tank.

NOTE: The cap nut can be hand-tightened. No tools required.

7d. If shut-off valve leaks or spray won't shut off:

If there is a leak between shut-off control valve and wand, or if spray will not shut off: Clean or replace O-rings on wand and shut-off valve.

If little or no spray is coming out of nozzle:

Brass Valve: Clean the valve ports with a toothpick and flush with water.

Poly Valve or Thrustless: Remove and clean out filter, if equipped, with water. New filters can be purchased.

Poly Shutoff Valve (69938) Filter: Part #152-360

Poly Thrustless (69943) Filter: Part #152-361

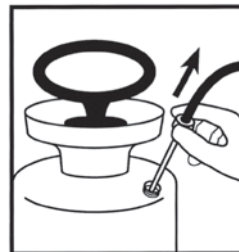

Make sure pressure is released **BEFORE** removing hose from valve or spray wand from valve. Make sure hose, wand and shut-off valve connections are tight before pressurizing.

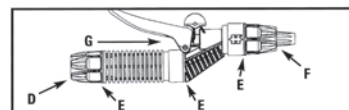
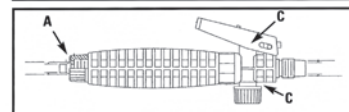
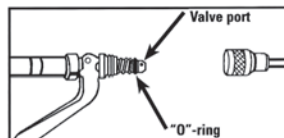

7e. If the nozzle leaks or becomes clogged:

CAUTION!

Make sure pressure is released **BEFORE** removing nozzle. Make sure nozzle is securely threaded back onto spray wand before pressurizing sprayer.

If there is leak between nozzle and spray wand: Release pressure, unscrew nozzle and clean or replace O-ring on the end of the wand.

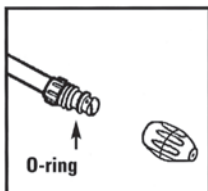

If nozzle becomes clogged: Release pressure, unscrew nozzle and clean nozzle orifice and ports at end of wand with a tooth pick or soft brush. (DO NOT use wire as this may damage nozzle) Flush with water and replace.

TIP: If nozzle, shut-off valve, or other parts seem clogged, remove the hose and supply tube and while holding shut-off valve open, flush the entire discharge line with water from your garden hose. If your sprayer continually clogs, dirt or debris may have gotten into the tank, if so, empty the contents of the tank into a bucket and then clean the hose and discharge line. Put a piece of cheesecloth over the tank opening before replacing the liquid in order to strain it when you pour the contents of the bucket back into the sprayer.

8 Here's where to get additional help and information

NOTE: Please do not ship your sprayer or parts to our office unless you are specifically requested to do so! Unsolicited returns to H. D. Hudson Manufacturing Company will not be accepted or acknowledged. Instead, phone 1-800-9-SPRAYER (1-800-977-7293) for assistance.

H. D. Hudson Manufacturing Company

500 N. Michigan Avenue

Chicago, IL 60611

Phone: (312) 644-2830

Fax: (312) 644-7989

Web: www.hdudson.com