



Long Life Rotor Blade Kit

20in or 21in Single-Stage Snowthrower

Model No. 38205

Installation Instructions

Before each season, inspect the rotor blades for wear. Refer to the *Operator's Manual* for proper inspection procedure.

Note: To make installing the kit easier replace one rotor blade at a time.

1

Removing the Old Rotor Blades

No Parts Required

Procedure

Note: Use Figure 1 as a reference for removing the old rotor blades as the existing parts are similar to the new ones.

1. Stop the engine, wait for all moving parts to stop, and disconnect the wire from the spark plug.
2. Remove the 4 locknuts and 4 countersunk bolts securing each side of the rotor blades to the rotor assembly.
3. Remove the 4 bolts (1/4–20 x 3/4) and 4 locknut (Figure 1).
4. Loosen but do not remove the bolt (1/4–20 x 1/4) and final locknut that secures the rotor blades to half rotors (Figure 1).

2

Installing the New Rotor Blades

Parts needed for this procedure:

4	Spacer
2	Rotor blade
13	Locknut
8	Countersunk bolt
4	Bolt (1/4–20 x 7/8)
1	Bolt (1/4–20 x 1/4)

Procedure

1. Secure the rotor blades and half rotors together using a bolt (1/4–20 x 1/4), 2 spacers, 5 locknuts, and 4 bolts (1/4–20 x 7/8) (Figure 1).

Note: Install the rotor blades with the thick rubber layer on the inside of the curve.

2. Secure each side of the rotor blades to the rotor assembly using 4 locknuts and 4 countersunk bolts (Figure 1).
3. Connect the wire to the spark plug.



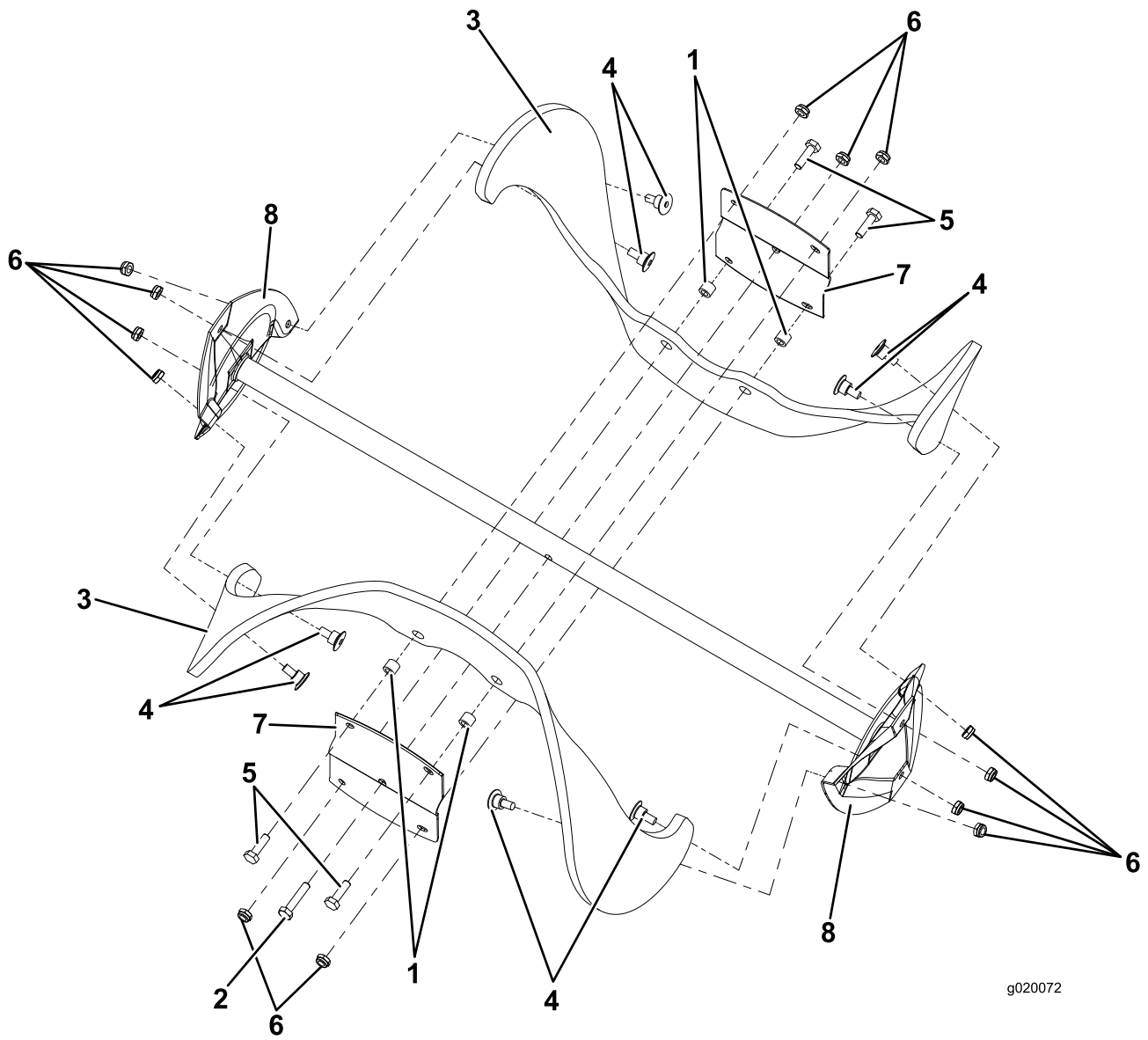

g020072

Figure 1

- | | | |
|------------------------|------------------------|-------------------|
| 1. Spacer | 4. Countersunk bolt | 7. Half rotors |
| 2. Bolt (1/4-20 x 1/4) | 5. Bolt (1/4-20 x 7/8) | 8. Rotor assembly |
| 3. Rotor blade | 6. Locknut | |